

## Annex F

ACT's overhead protection system



All you need to know about  
the FRACO platform

98030617-00 (MU-OVER-AN 10-2004)



## Table of contents

***Annex F:***  
*ACT's overhead protection system installation*



## Annex F

### ACT's overhead protection system installation

#### In this section:

• General view .....	I-1
• Overhead support assembly .....	
○ Platform overhead support .....	I-2
○ Elevating unit overhead support .....	I-3
• Way to install the overhead support .....	I-4
• Support installation .....	
○ Installation on the platform .....	I-5
○ Installation at the end of the platform .....	I-6
○ Installation on the elevating unit .....	I-7
• Roof installation .....	I-8
• 2 <sup>nd</sup> level working area .....	
○ Outrigger installation .....	I-9
○ Outrigger planks installation .....	I-10
○ Outrigger guardrail installation .....	I-11
○ Outrigger guardrail planks installation .....	I-12
○ Plank end guardrail installation .....	I-13
• Overhead system tarp installation .....	I-14

## General view

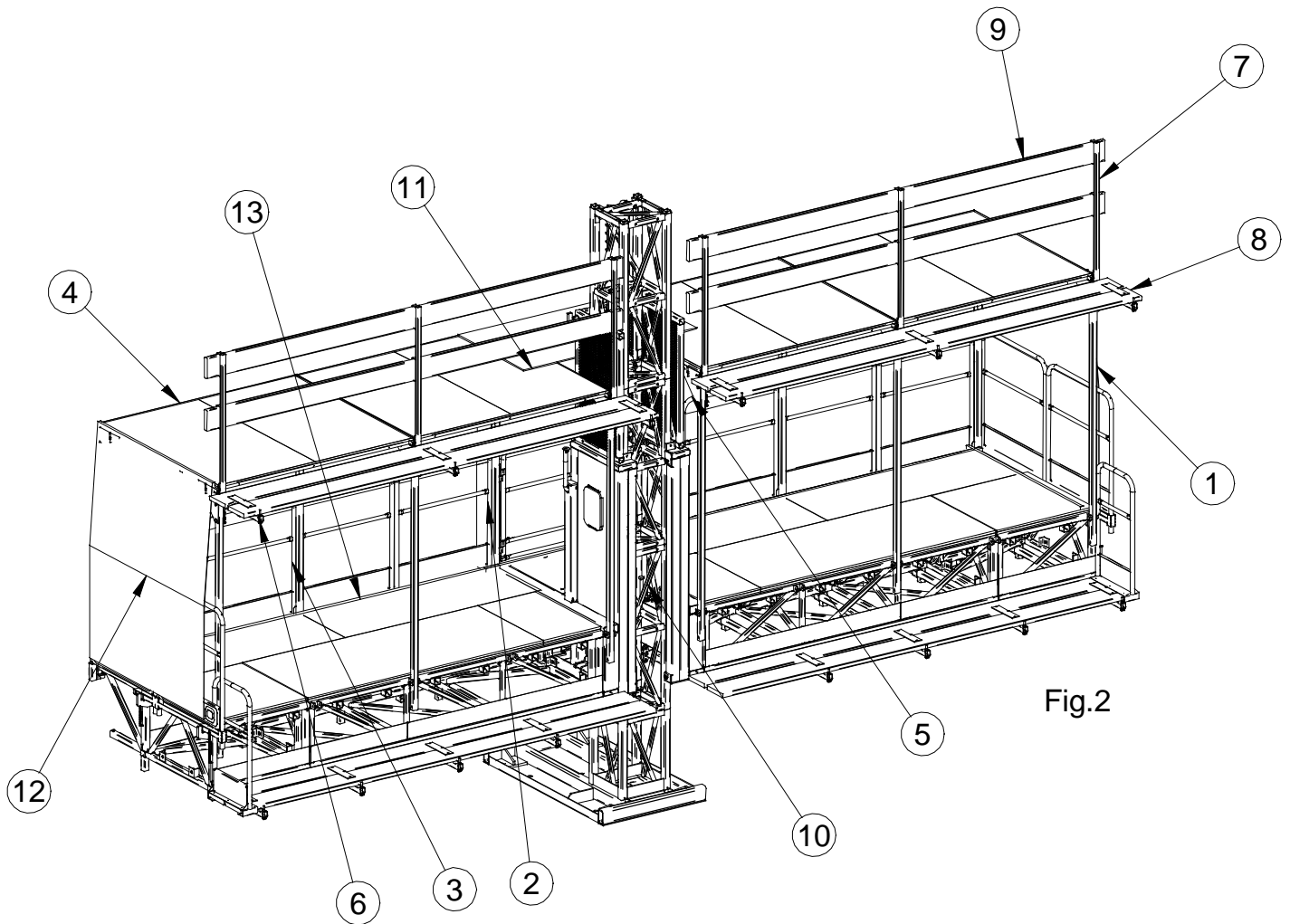

Fig.2

<u>Part identification</u>	
Item #	<i>Description</i>
1	Front bracket
2	Rear bracket (elevating unit)
3	Rear bracket
4	Roof structure
5	Top bracket
6	Outrigger
7	Outrigger guardrail
8	Plank
9	Outrigger guardrail plank
10	ACT elevating unit
11	Plywood
12	End platform tarp
13	Platform tarp

# Overhead support assembly

## On the platform

installation:

- 1-Install the front support using the right holes in the top support.(Det.1)
- 2-Install the rear support using the right holes in the top support. (Det.2)
- 3-Lock the front & rear part using locking pin with safety pin. (Det 1 & Det. 2)

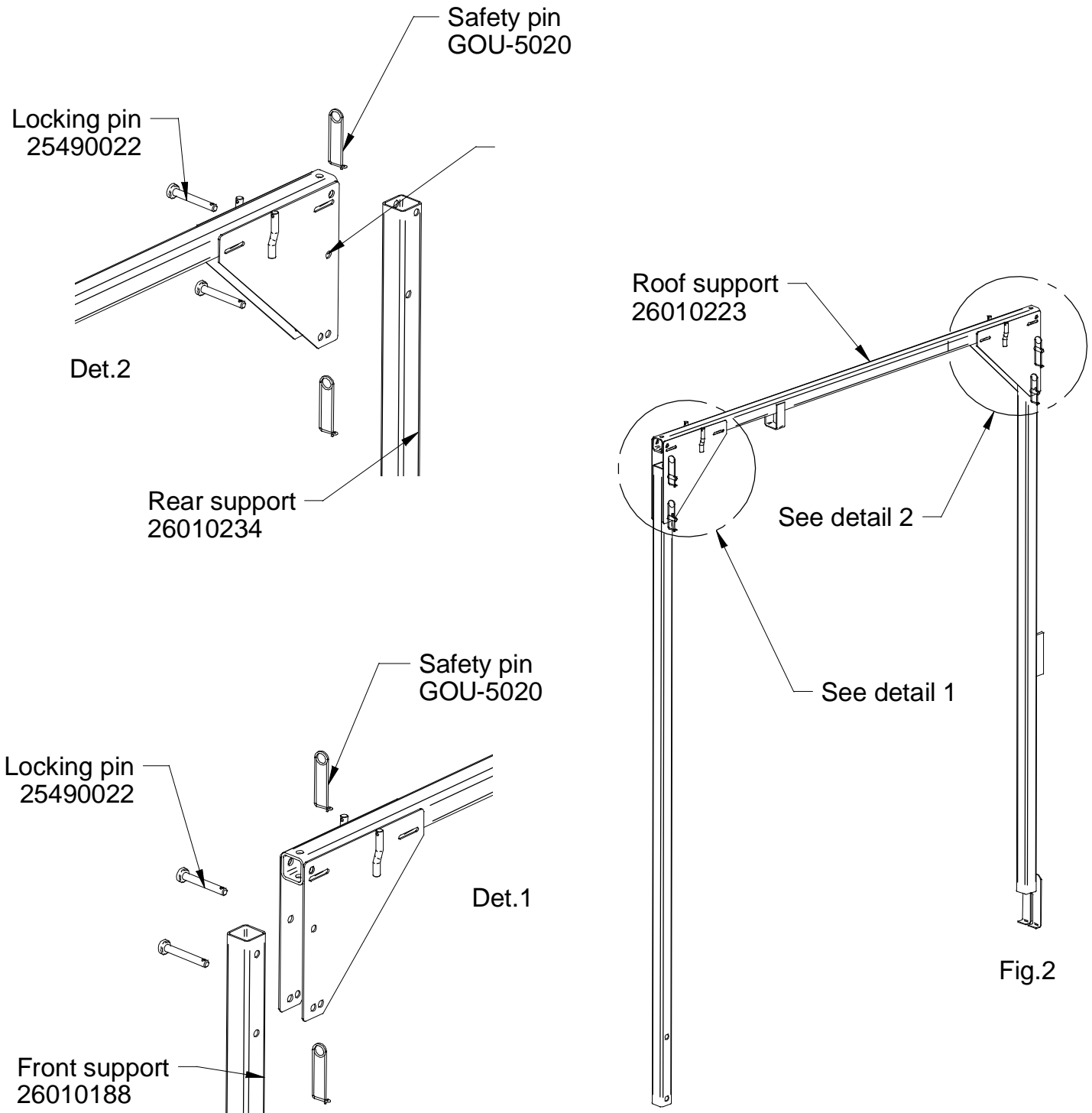

# **Overhead support assembly**

## Installation on the elevating unit

### Installation:

- 1-Install the front support using the right holes in the top support.(Det.3)
- 2-Install the rear support using the right holes in the top support. (Det.4)
- 3-Lock the front & rear part using locking pin with safety pin. (Det 3 & Det. 4)

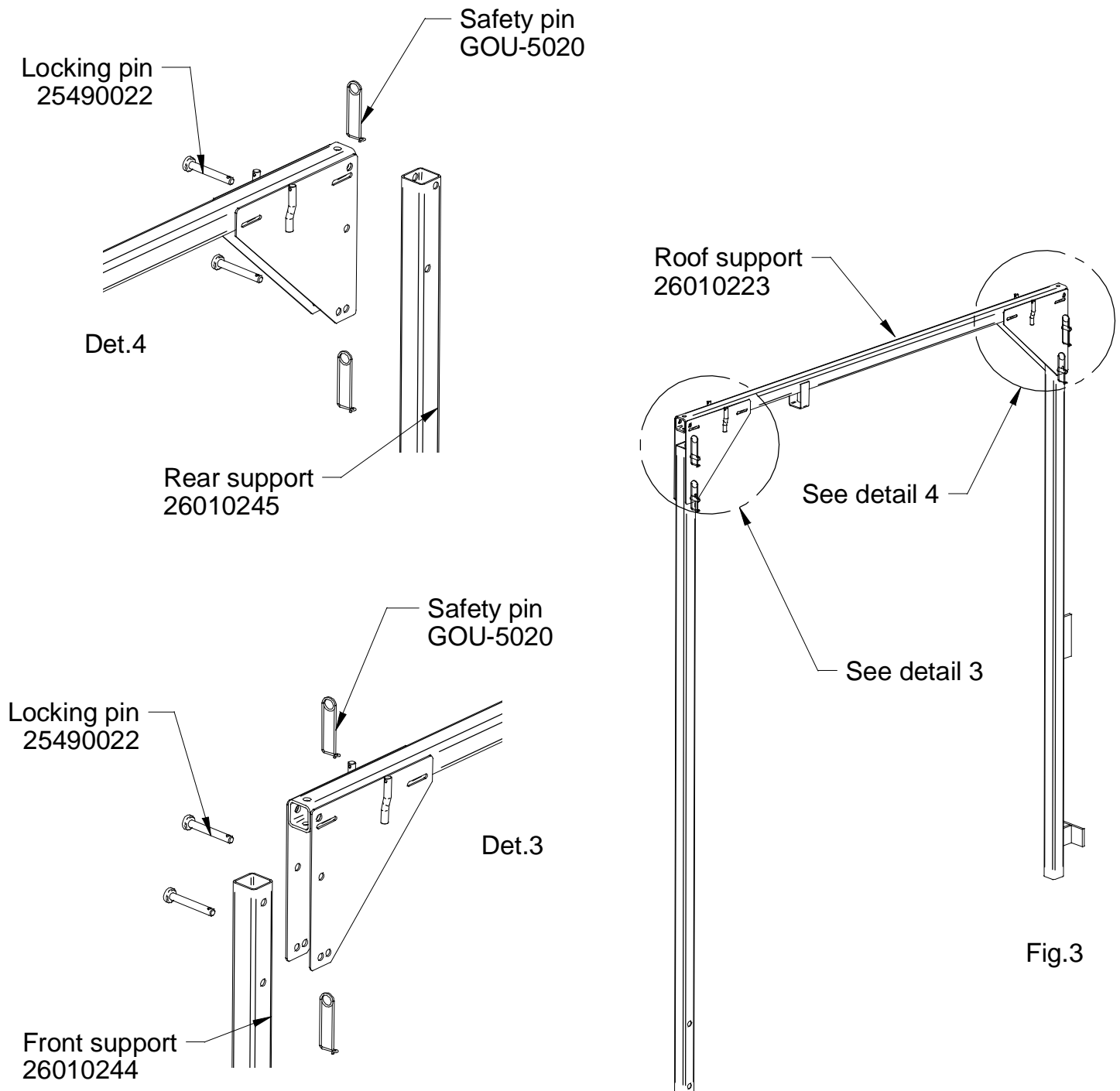

# Way to install the overhead protection

## Installation:

### Horizontal roof

1-Use the holes as shown on the front support (Det.6) and the holes on the rear support (Det.5) to set up the roof horizontally.

### Angle roof

2-Use the holes as shown on the front support (Det.6) and the holes on the rear support (Det.5) to set up an angle roof.

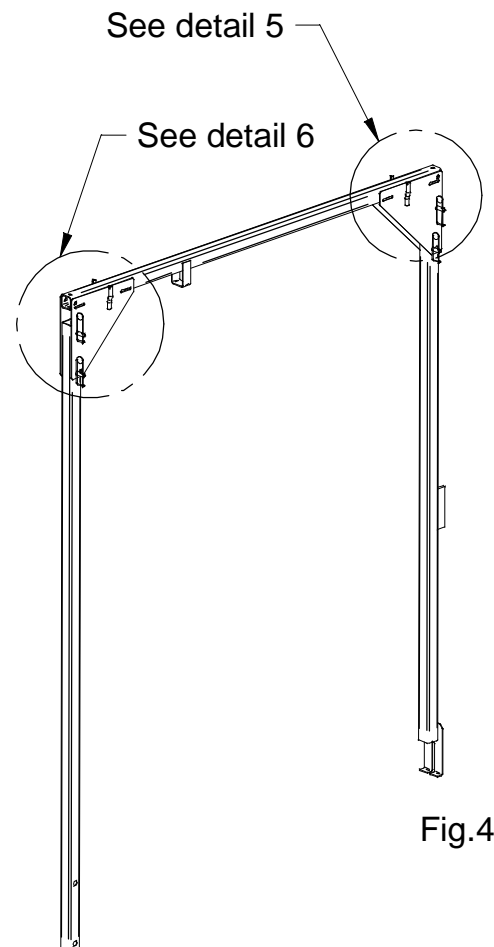
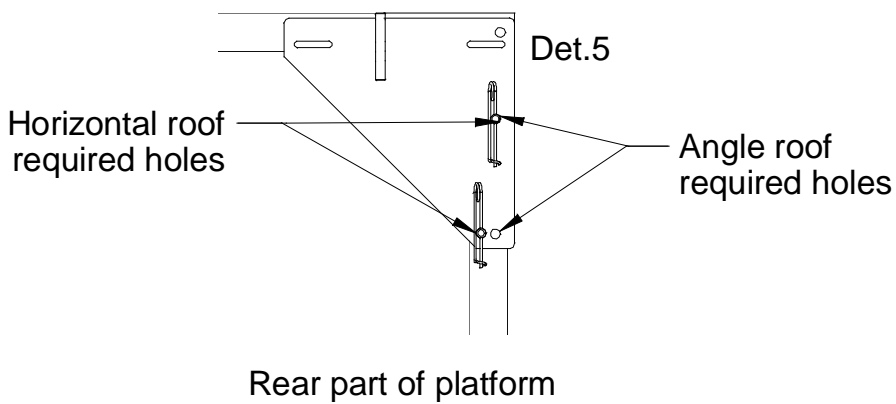
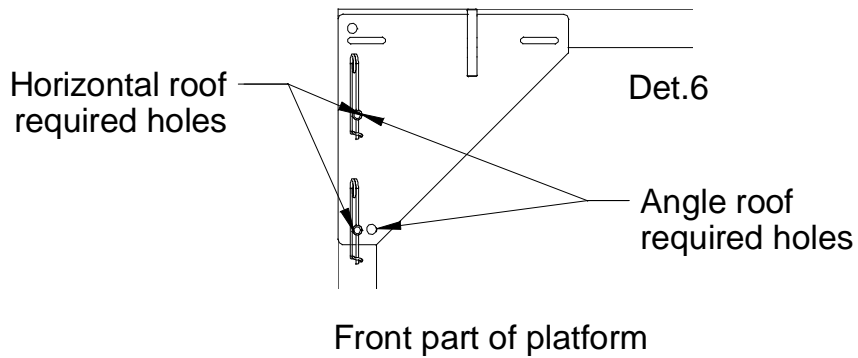

## **Bracket installation**

Middle of platform

### Front part of the platform:

- 1-Use the right hole to the set up needed. (Det.7)
- 2-Lock the bracket with lock and cotter pin.

### Rear part of the platform :

- 1-Remove the guardrails and insert the bracket to the guardrail adaptor. (Det.8) Replace the guardrail to their position.  
(Make sure that the bracket will set closer as possible to the platform.)

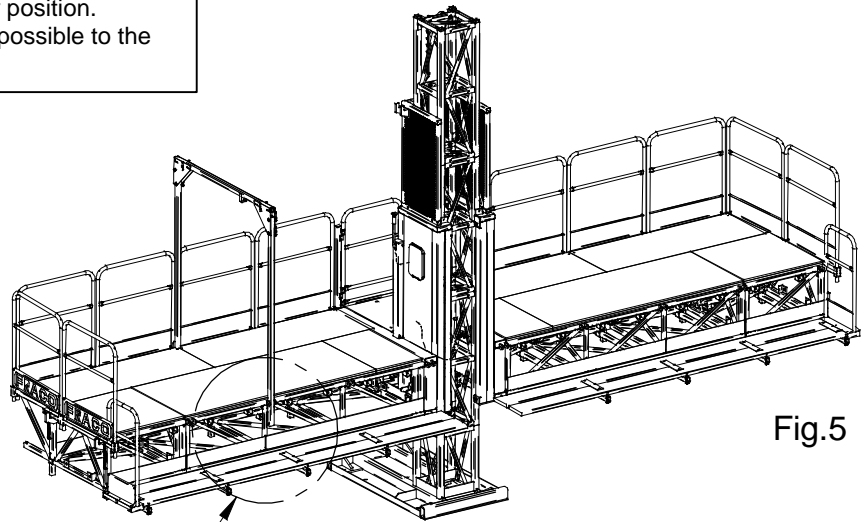
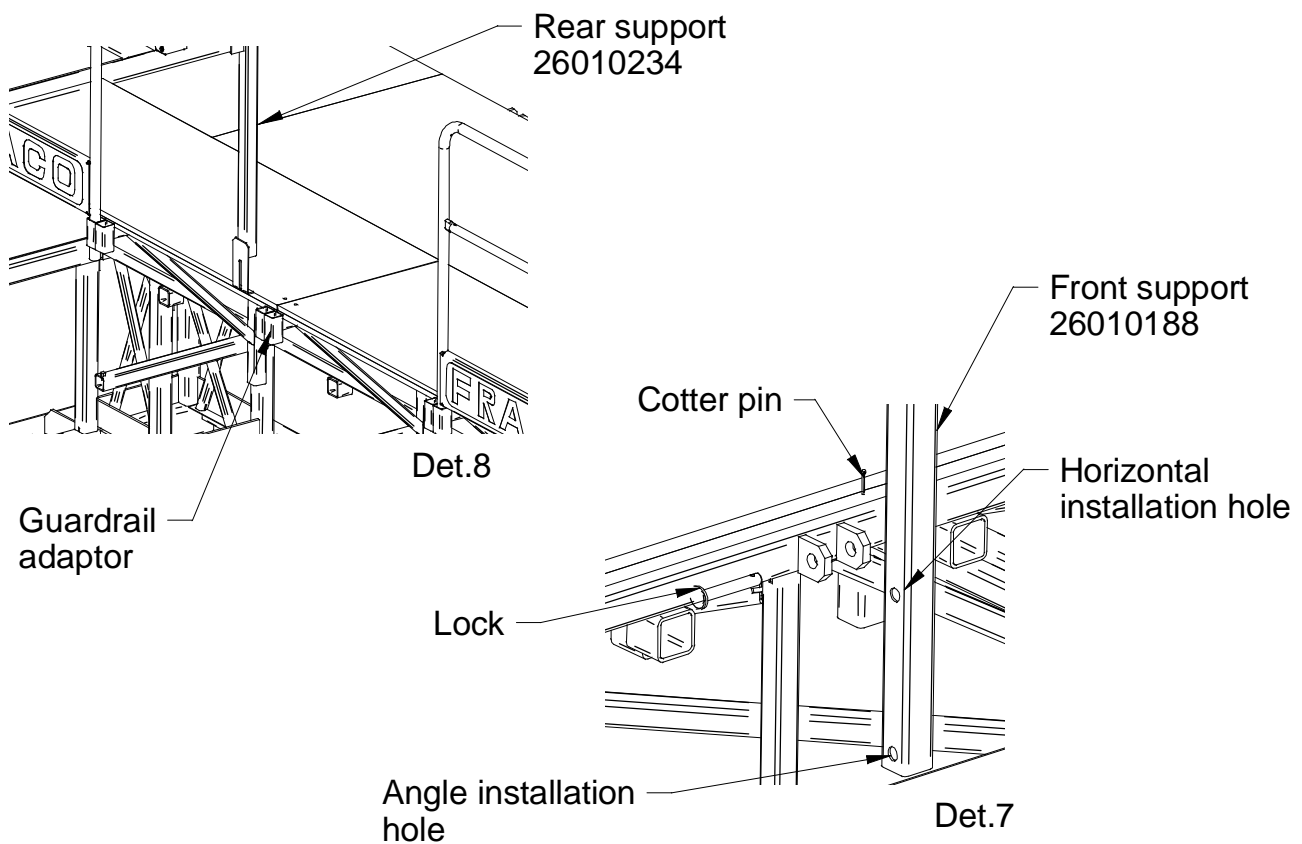

Fig.5

See detail 7-8





# **Bracket installation**

## Elevating unit

### Installation :

#### Partie avant de la plate-forme :

- 1-Use the right hole to the set up needed. (Det.9)
- 2-Lock the bracket with lock and cotter pin. (Det.9)

#### Partie arrière de la plate-forme :

- 1-Remove the guardrail on each side of the access door. (Det.10)
- 2-Put in place the bracket .(Det.10)
- 3-Replace the guardrail to their position to holt the bracket in place (Det.10)

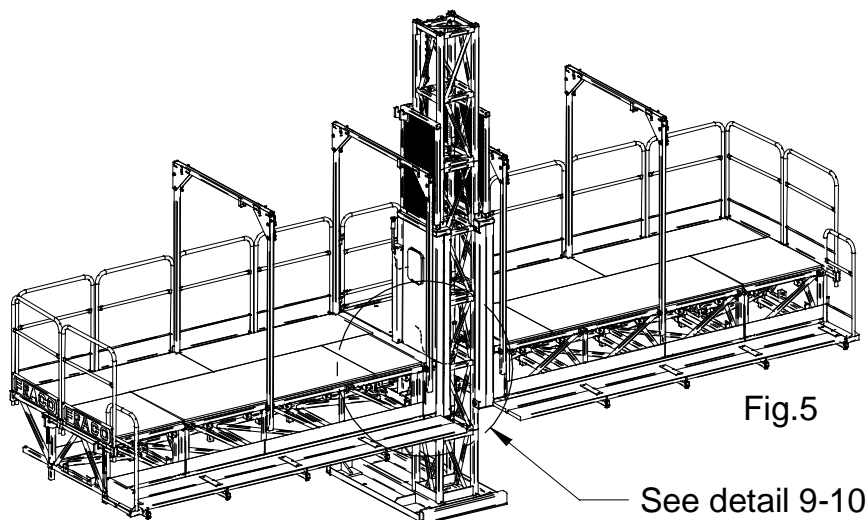
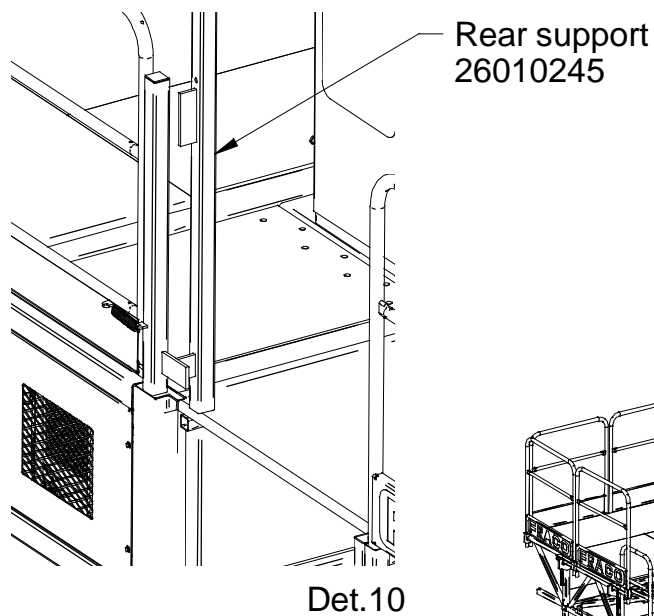
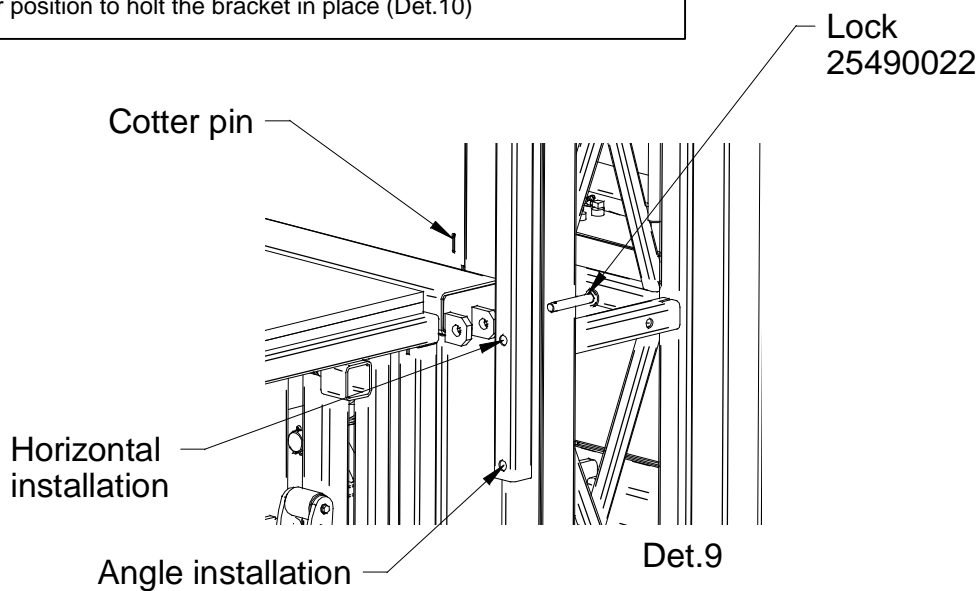

# **Bracket installation**

## **End of platform**

- 1-Remove the corner guardrail. (Det.11)
- 2-Insert a guardrail adaptor. (Det.11)
- 3-Lock the adaptor using a safety lock. (Det.11)
- 4-Replace the guardrail..

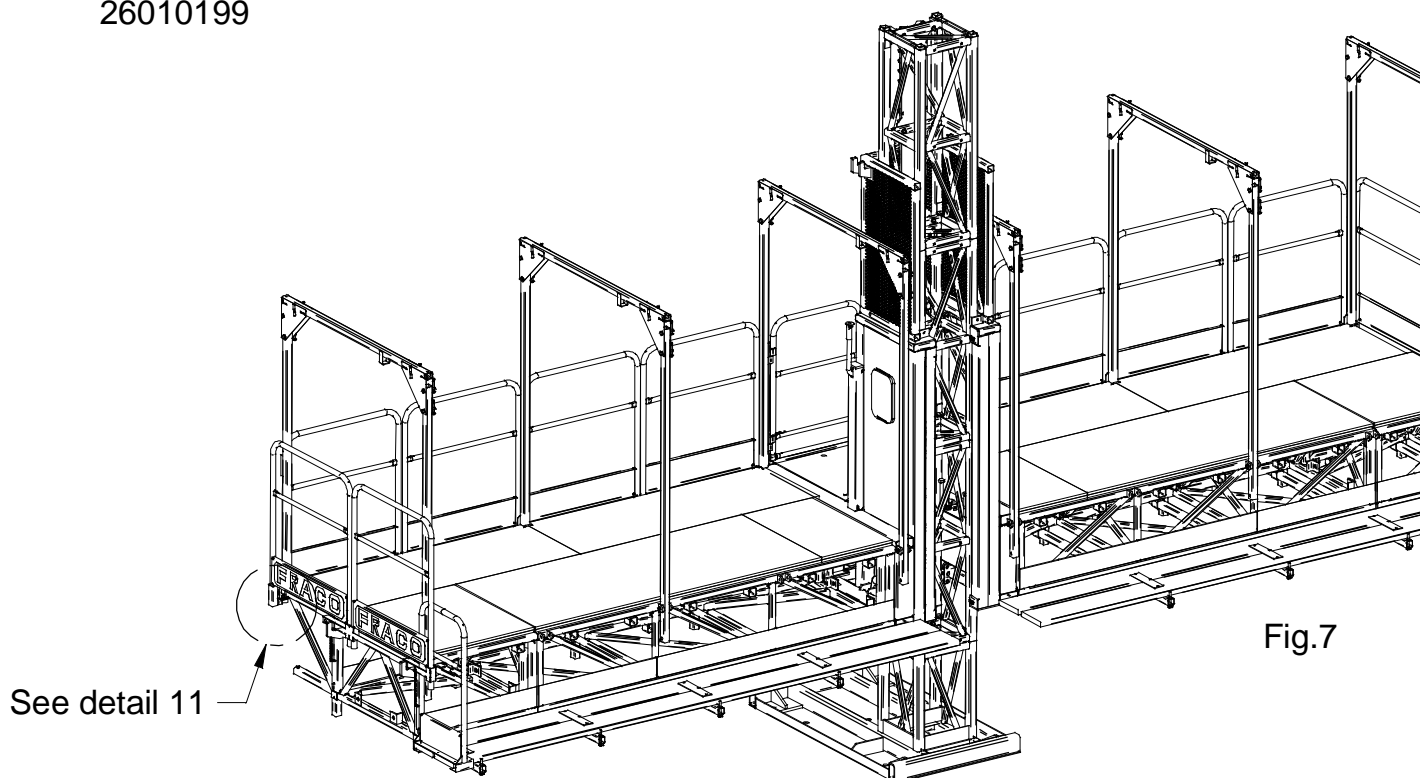
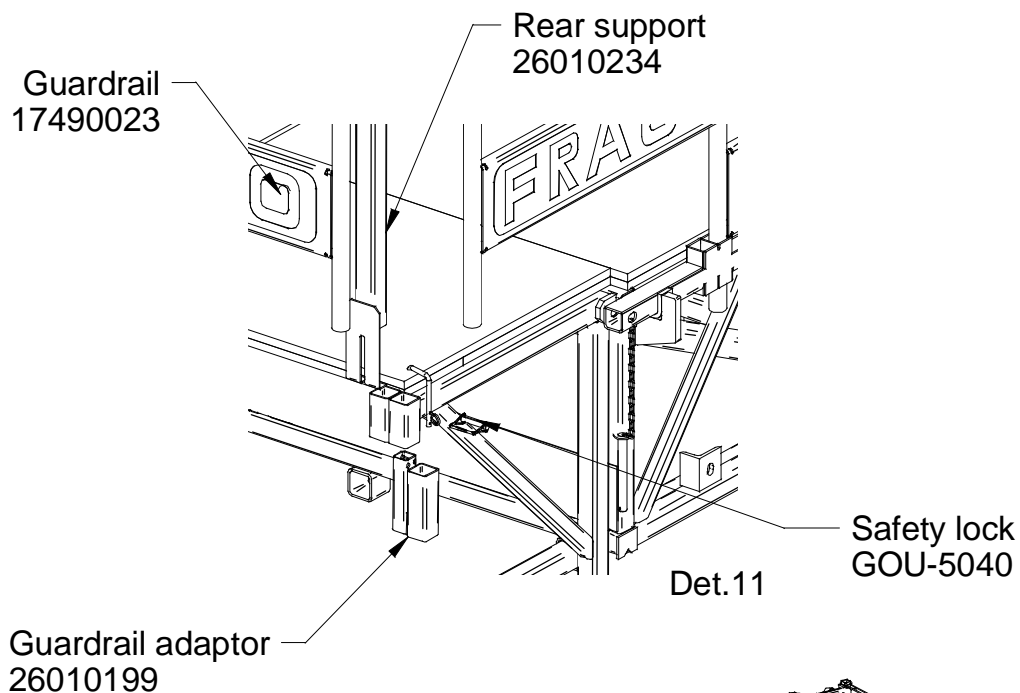

## Roof installation

- 1-Install the roof on the welded axle on roof support. (Det.13)  
2-Lock it using safety pin.

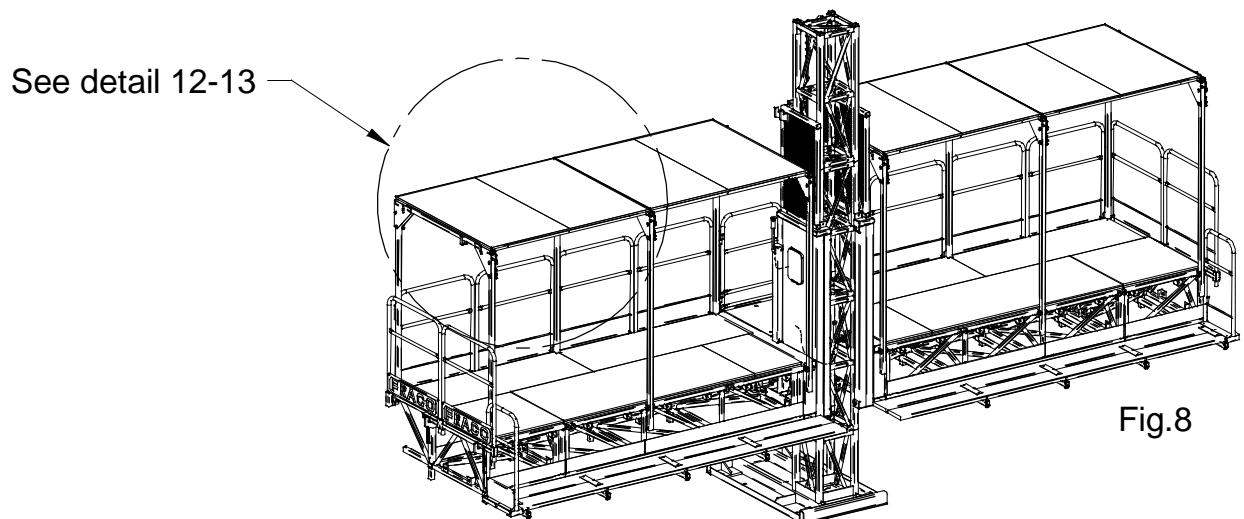
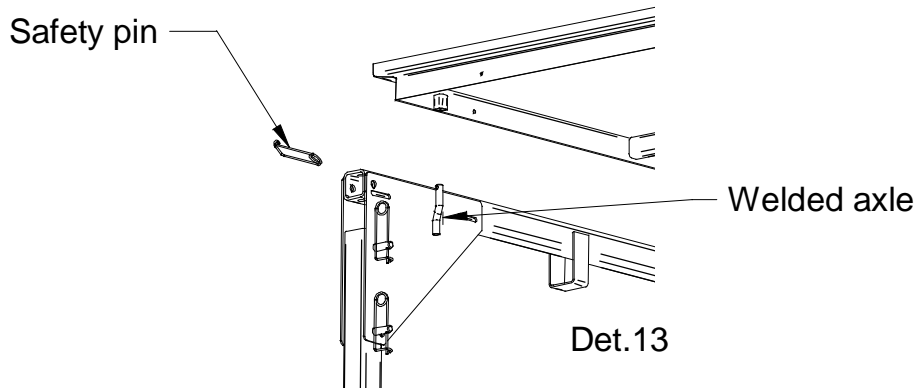
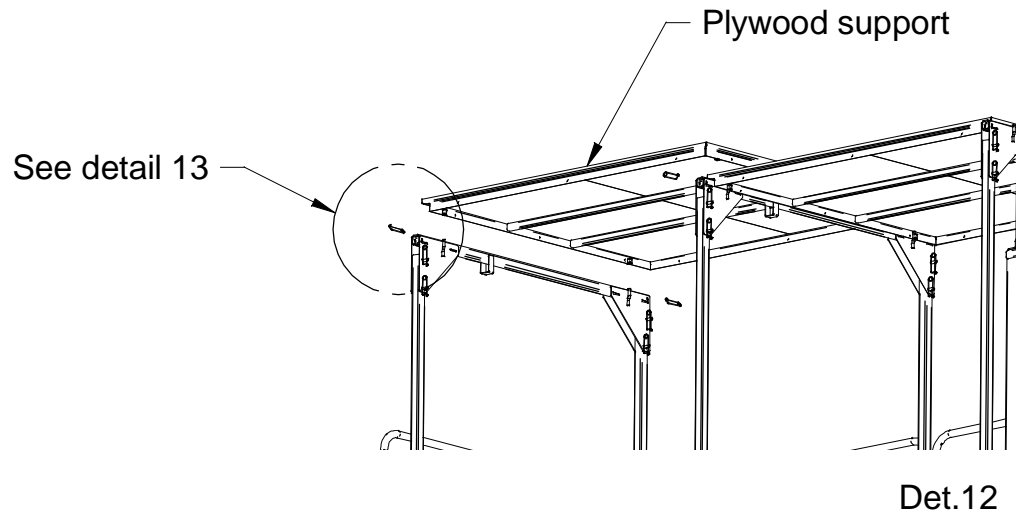

## **2<sup>nd</sup> level working area**

### **Outrigger installation**

- 1-Insert the outrigger in the roof support ( Det.14) and make sure that the bolt is set down.
- 2-Slide the outrigger to the front and put a lock with washer and cotter pin. (Det.15)

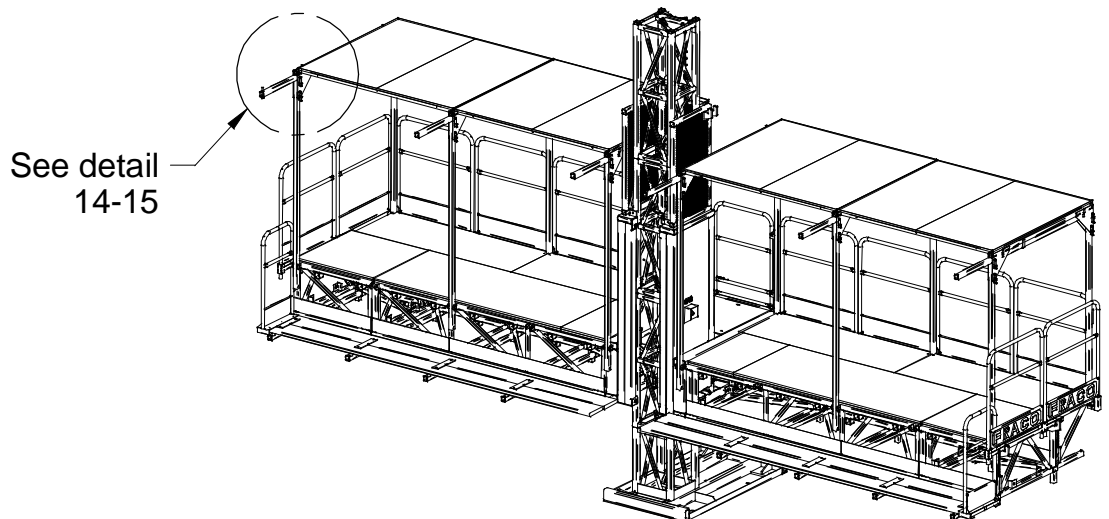
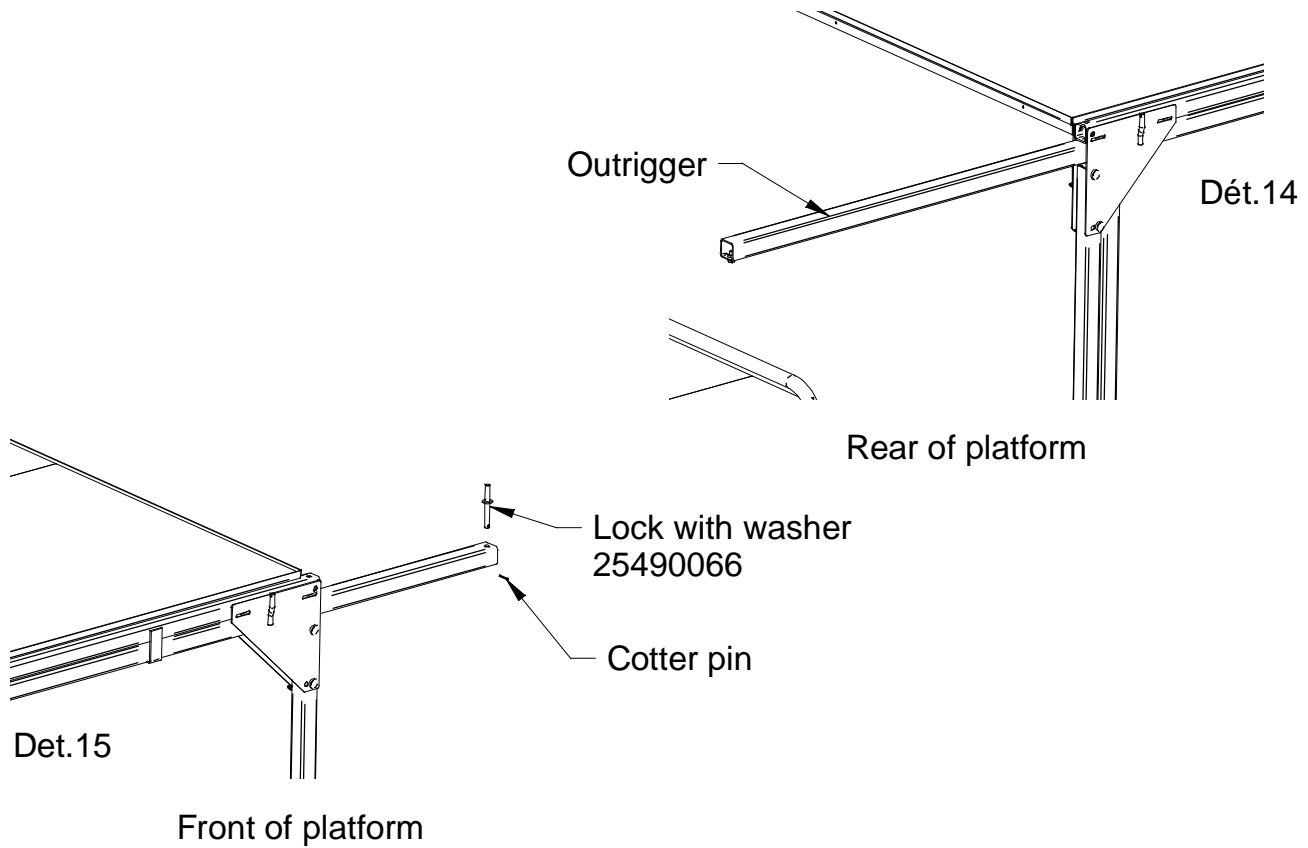
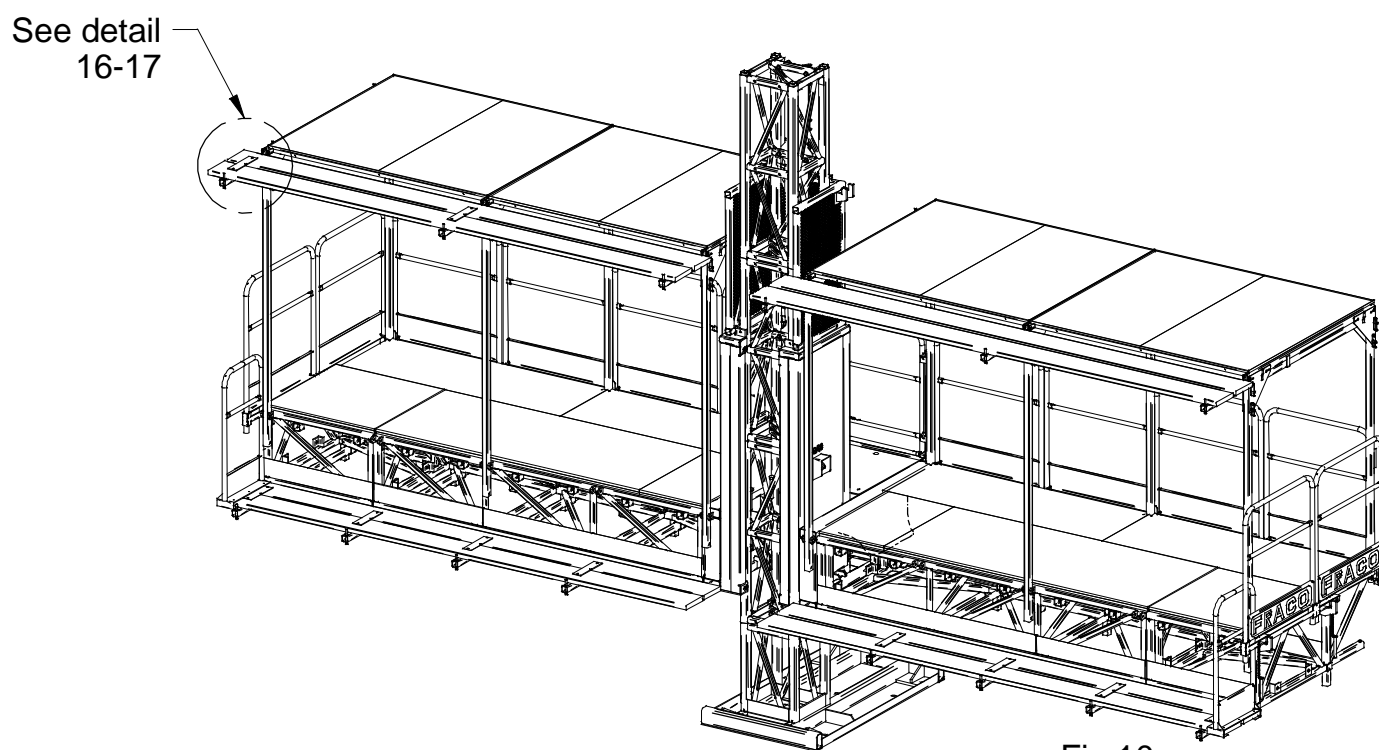
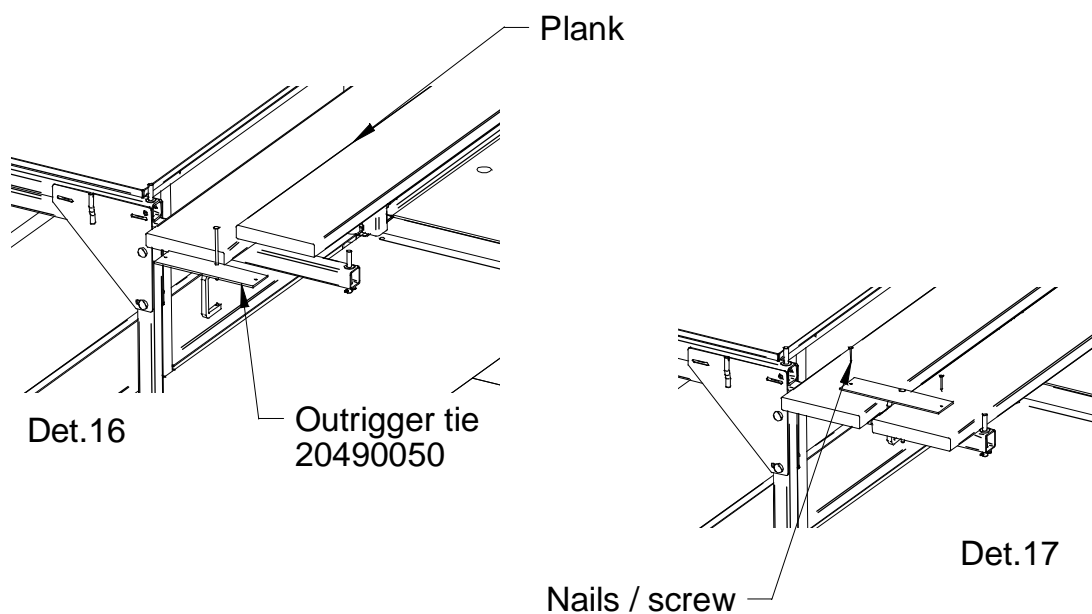

Fig.9

## **2<sup>nd</sup> level working area**

### **Outrigger plank installation**

- 1-Install the outrigger planks and lock them using outrigger tie. (Det.16)
- 2-Use nail or screw to hold the outrigger tie. (Det.17)



## 2<sup>nd</sup> level working area

### Outrigger guardrail installation

- 1-Insert the guardrail in the top support. (Det.18)
- 2-Lock the guardrail using lock with washer. (Det.18)

Outrigger guardrail  
17490067

Lock with washer  
25490066

Det.18

see detail 18

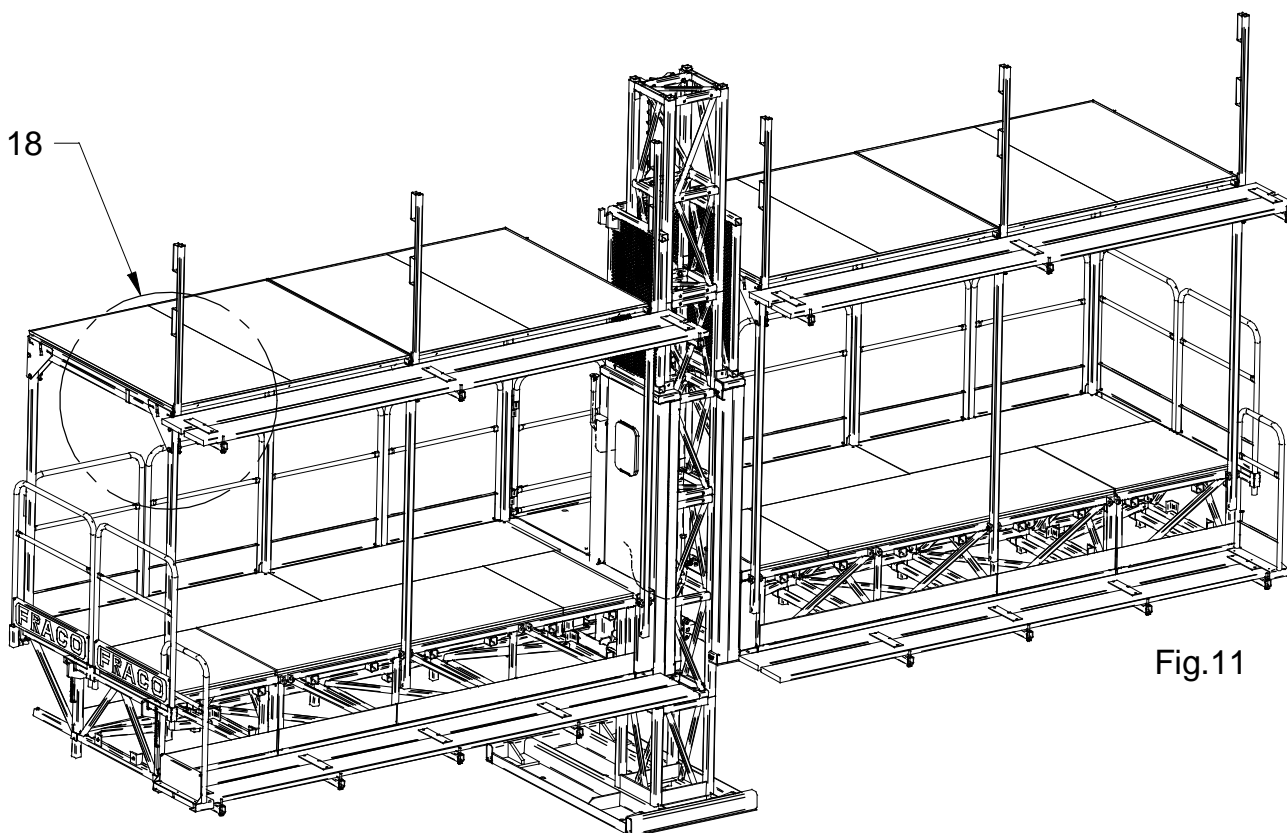
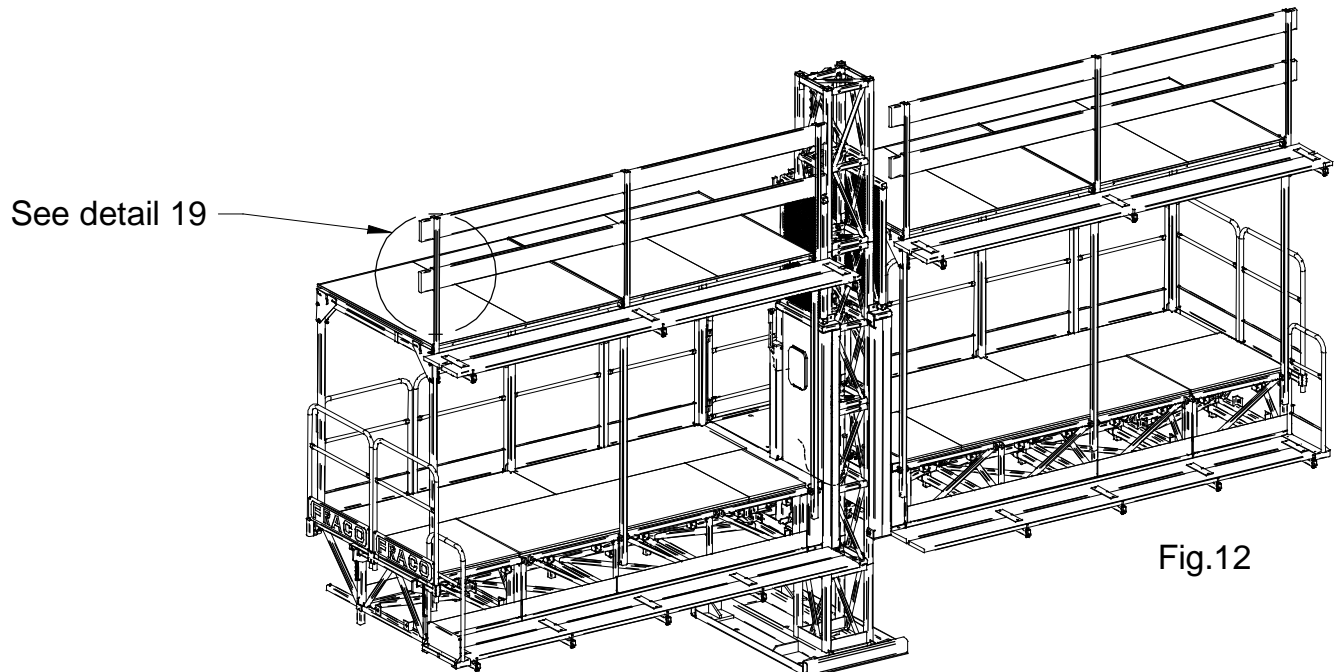
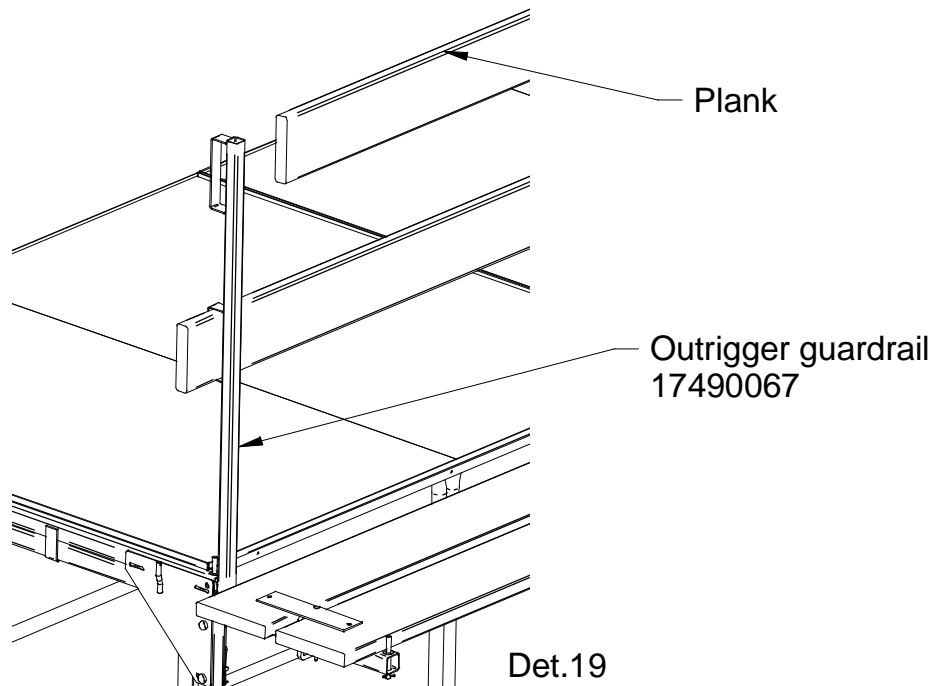

Fig.11

## **2<sup>nd</sup> level working area**

### **Outrigger guardrail plank installation**

- 1-Insert the plank in the guardrail support. (Det.19)  
2-Use nails or screw to hold the plank in place.



## **2<sup>nd</sup> level working area**

### **Plank end guardrail installation**

- 1-Insert the plank end guardrail on the planks. (Det.20)
- 2-Use nails or screw to hold the guardrail.

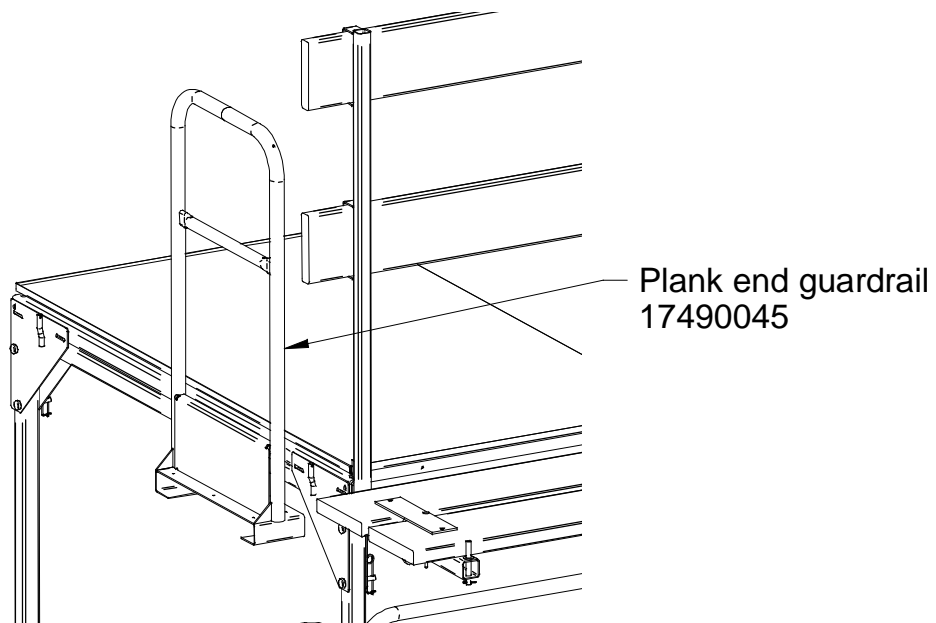

Det.20

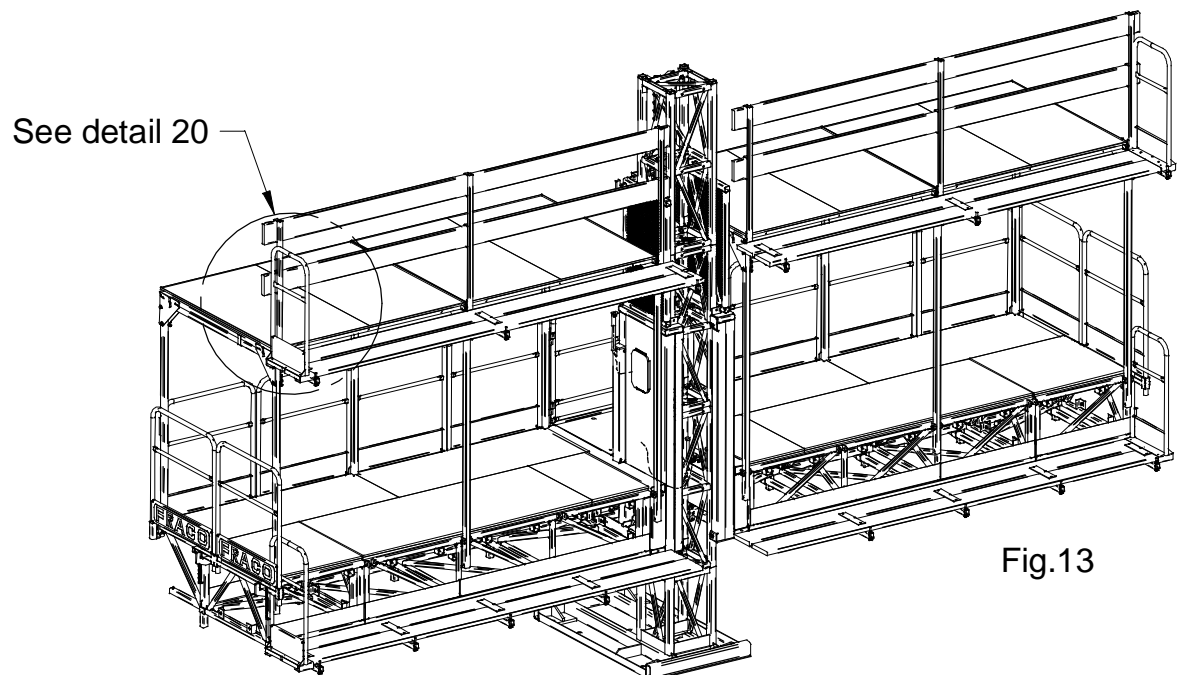

Fig.13



## Overhead protection with tarp

- 1-Measure the necessary length of tarp to fit the length of the platform.
- 2-Roll the top of the tarp around a forence & secure in place with screw into the top part of the frame (Det.21)
- 3-Roll the bottom of the tarp around a forence until the tarp is tight. Secure to the plywood using nails or wood screw.

### Toit horizontal:

- 4-To close the end of the platform on a horizontal roof; repeat steps 1 to 3

### Toit à angle:

- 5-Roll the tarp around the forence at the same angle to close the end properly.

- 6-Install the access door tarp following the steps 1 to 3.

- 7-Install a plywood to close the space between the extension. (Det.22)

